



Wo bi ya luui ne webthait de Compass ago koc ke paanduon ya cok jam kenne thukul de Copperfield College. Yin leu ba ya lo ne webthait de Compass ne telepunduon to kenne yin wenno kombiotar nojic internet.

KÄ TÖ THİN ETENNĒ	APÄM
Lo bin ya lo webthait de Compass yic ne doorduon tueenji: Nö kombiotar de Desktop yic / kombiotar de Laptop yic	1-3
Lo bin ya lo ne App e telepun de Compass yic ne doorduon tueenji: Ba ya yok ne App store yic	4-8

Lo bin ya lo ne webthait de Compass yic ne doorduon tueenji: **Nö kombiotar de Desktop yic / kombiotar de laptop yic**

1. Ago ya lo thin, yin bi kon ya naŋ rinkuon ke paanduon ye wuoc kenne rin ke koc koc peei, men ye cole "unique family username" ku ba nom ya naŋ "password". Erin kake abi ya to eke ci keek gam yin wenthær ne thukulduon, ku na noot eke kenne keek yok, ke yi yupe maktam de thukulic ku ka bi yin ya gam kee wel kake.

Nimira de maktam de Sydenham: 9361 3888
 Nimira de maktam de Kings Park: 9365 4111
 Nimira de maktam de Delahey: 9307 5555

Kö koc ba nyic apieth — Password: thukul abi yin ya gam password thiin leu ba ya doc geer ago ne doorduon tueenji ago yin ya lo ne webthait de compass yic.

To login, go to your school's Compass site. Type in your username and password and click 'Sign in'.

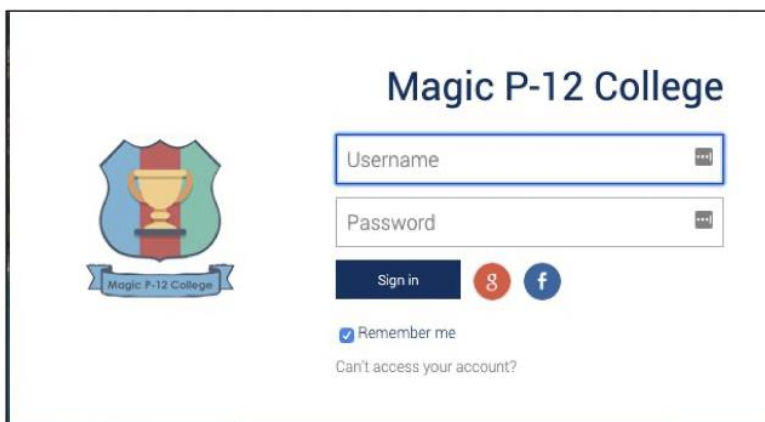

2. Na ca lo thin ne webthait de compass yic, ke yin bi ya koc ba yimeildu ku nimira de telepundu ya kon deetic apieth ku ba gam ke ci jal piath.

Welcome to the Magic P-12 College Parent Portal

Please confirm your mobile phone number and email address(es) below. These details will be used by the school to keep you up to date on school news, upcoming events, student absences, fees due for payment and a range of other information services (depending on the Compass features your school uses).

Mrs Sable BROOKS

Mobile

Email

3. Akɔɔr ba ye password thiin awɛn cɛ gɛm yɛn kɛnnɛ ya geer nɛ **password duʒɔn ca nhiaar**.

Next, you will need to change your password

Your new password must:

- Not contain your username
- Not be a password recently used by this account
- Be **at least eight (8) characters** in length
- Contain **at least one (1) UPPERCASE letter**
- Contain **at least one (1) lowercase letter**
- Contain **at least one (1) number**

New Password:

Confirm New Password:

Na ca **password duʒɔn ca nhiaar kɛnnɛ** kuany, ke yɛ thany tɛ cɛ gɔɔric ke yee ‘Save’ nɛ thoŋ ɛ Liŋɛlith.

****ɛkɛnnɛ yennɛke kueerduʒɔn tueeŋ lɛu bɛn ya lo nɛ wɛbthait de compass yic nɛ doorduʒɔn tueeŋic.****

4. Na ca thɛn, ke yɛn bɛ lo tɛ cɛ gɔɔr ke ye “Home page” nɛ thoŋ ɛ Liŋɛlithic. ɛkɛnnɛ yennɛke tɛn ben ya tɔu thɛn ɛnoŋ yɛn.

The screenshot shows the home page of the Magic P-12 College Parent Portal. At the top, it says 'Welcome to the Magic P-12 College Parent Portal' and 'Compass'. Below this, there's a 'My News' section with several items: 'Order your MSP school photos', 'Alerts for Action', 'Course Confirmation/School Payments', 'Payments', and 'Event Consent/Payment Required'. There's also a 'Newsletter' section and a 'School Jumper Orders' section. On the left, there's a 'Child Information' section with profiles for Stephen CORNFOT and Euan ABERCROMBIE, each with links to their profile, send email to teachers, add attendance notes, and view academic reports.

Lo bin ya lo nē App ē telepun de Compass yic nē doorduōn tueenĭc: Ba ya yōk nē App store yic

Kē kōr ba ya nyic: App de Compass abī ya yōk nē App store yic, ēnōĭ kōc nōĭ nhīim telepuun ke iPhone, ku jōl ya Google Play, ēnōĭ telepuun ke Samsung, ku jōl ya kōc nōĭ nhīim telepuun juēc kōk peei. Ūen muk telepun de iPhone nē yemēen, ku na yīn ya, ke ŷen bī week caath nē kuēer nyicē keek wēnthēer yiic, ago App de Compass ya miētbei nē App store yic ku ba tāau nē telepundu yic.

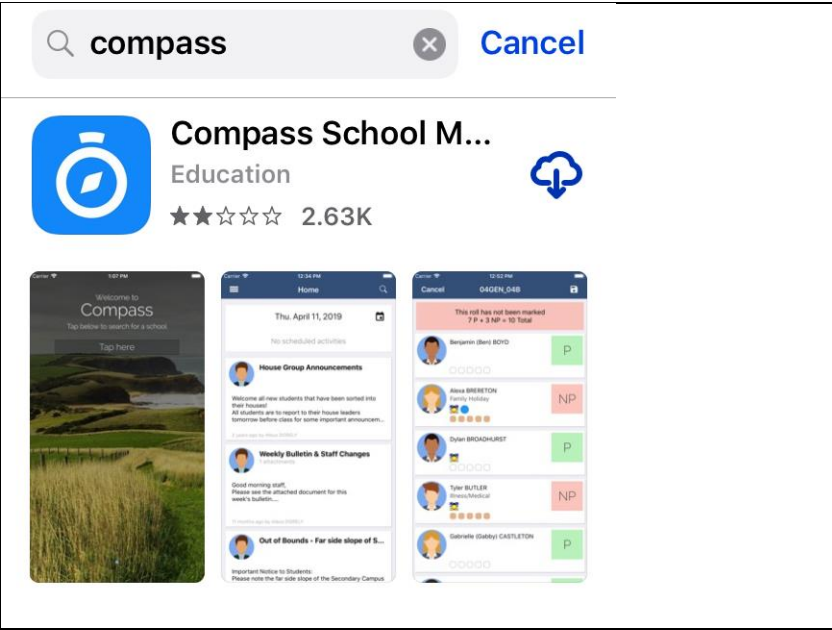
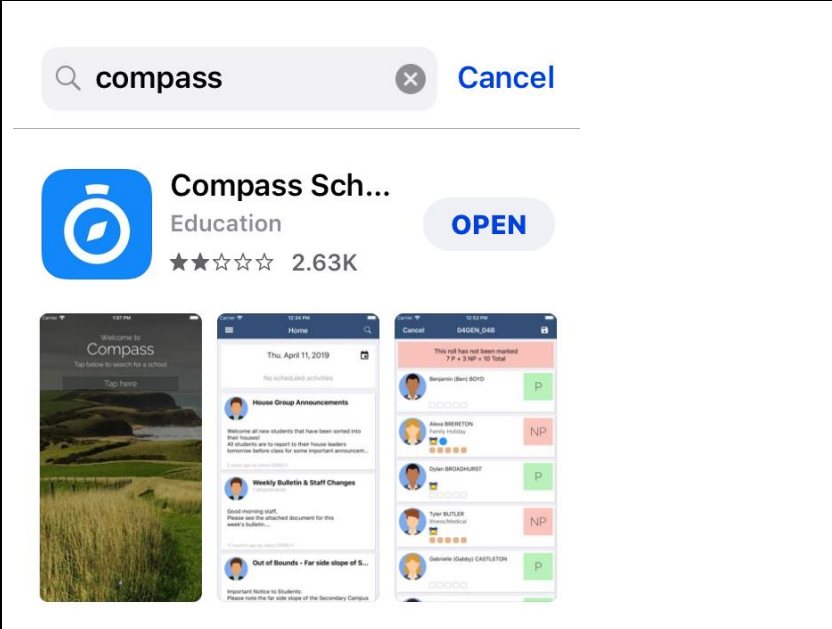
	<p>1. Na ca <u>App store</u> liepic, ke yī gāārē wēt ye cōlē ‘compass’ tē yennē wēl guik thīn ētēnnē ye cōlē “search bar”, men ba ya yōk nē baĭ nhial de maraya de telepundu.</p> <p>Kueer tōĭ bin yekēnnē ya nyic men cīn App lōĭok gutic, ee tē bin athuōōr (logo) nōĭĭc kīn dīit maĭōĭ nōĭĭc kīn thiin dēt yer ēyadēĭ ya tīĭ.</p>
	<p>2. Na ca ye App kēnnē miētbei, ke yī thany tē cī gōōric ke ye ‘open’ nē thoĭ ē liĭēlith, ago liep.</p>

Welcome to
Compass

Tap below to search for a school

Tap here

Begin by typing your school name

Copper

Copperfield College

3. App de compass abī yīn lær nē apām bī yīn luōōr thīn. Nē ye kē ca nyuōōth kēnnē yic, ɣen bī wēt ye colē 'Copper' guōt thīn ke wēt ye colē 'Copperfield College' kēn guō bēn. Thany tē cī gōōr ke ye 'Copperfield College'.

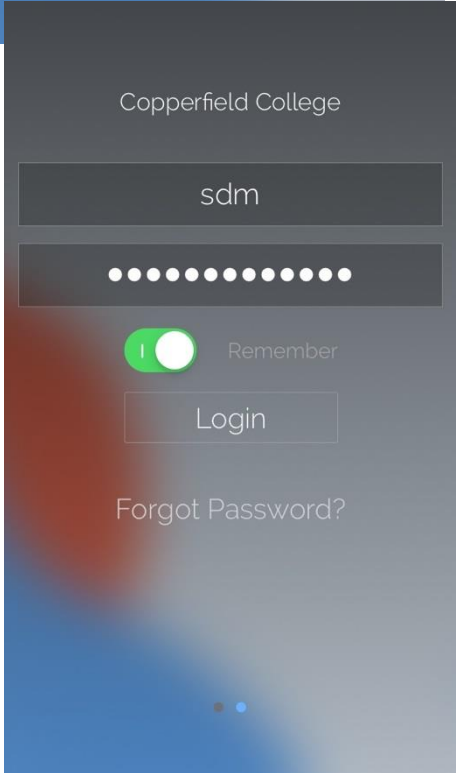
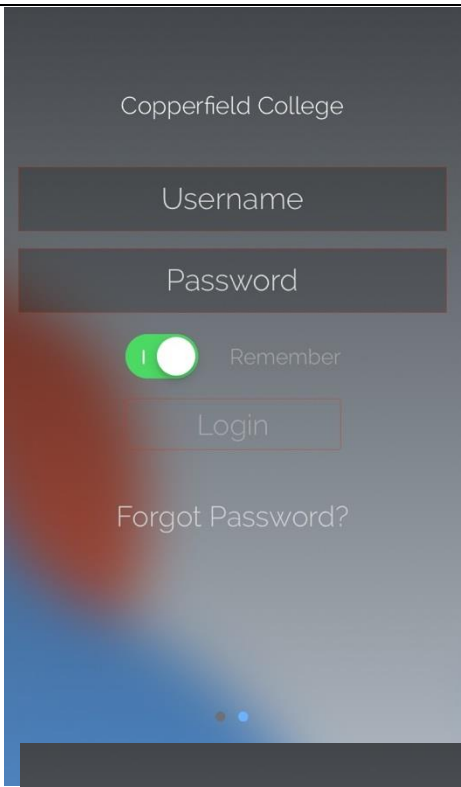

4. Yin bī lær nē ye apām kēnnē yic, mēn bī yīn thiēc rinku ku jol ya pāthwāardu (username and password).

Ago ya lo thīn, yīn bī kōn ya naŋ **rinkuōōn ke paanduōōn ye wuōōc kēnnē rin ke kōc kōk peei**, mēn ye colē **“unique family username”** ku ba nhom ya naŋ **“password”**.

*Na kōor ba wēl juēc bīn keek ya lo thīn ya yōk, ke yī dhuōkē nhial nē baŋ cī gōōr ke ye wēl ke nyuuth nē baŋ de **kōmbiōtar de Desktop / kōmbiōtar de laptop**.

Yuōpē māktam de thukulduōōn tē kōor yīn kee wēl kākē (nīmīra de telepuun nē apām 1)

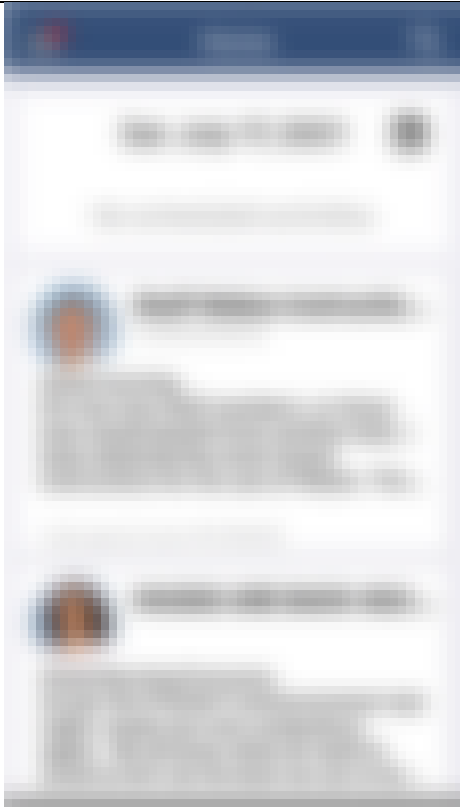

5. Yin bī maraya de telepundu cī gōör ke ye 'Home' ya tīŋ.

Na ca lo nē App de compass yic apieth, ke yin bī ya nyuöth maraya de telepundu cī gōör ke ye 'Home'.

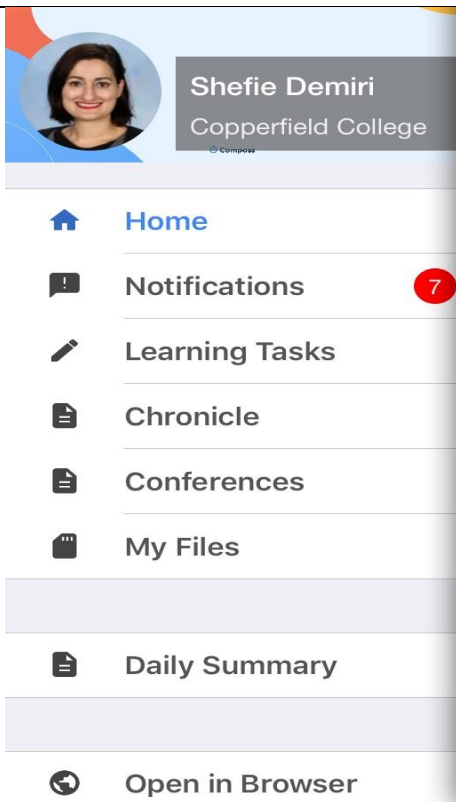

6. Nē maraya de telepunduöön cī gōör ke ye 'Home' ëtëën, yin bī abeer kee 3 ya tīŋ ëtënnë nē baŋ ciεm de telepundu nyin. Thany ë wurum kënnë ago kë cī gōör nē baŋ thīn ya deetic.

Kä tueeŋ bi yin ya nyuöth nē App de compass yic:

Të cī gōör ke ye "Notifications":
 Ëtënnë yennëke të bīn wël cī keek lueel kedhiε nē dupiöoc ke Copperfield College ya yök thīn.

Të cī gōör ke ye "Learning Tasks":
 Ëtënnë yennëke të bīn ya yök nē wël ke kä bennëke yin ya piöoc, mēn ye colë "Learning Tasks" cī mēn de (CATs/SACs/assessments).

	<p><i>Të cī gǝǝr ke ye “Chronicle”:</i> Ètënnë yennëke të bīn ya yök në wël cī keek lueel kedhiε në kë de aciëëk ke meth.</p>
--	---